



RP1600

Rugged and Professional Android Smartphone

The Rugged Smartphone armed with Octa-Core processor and Sizable RAM

The RP1600 is powerful smartphone with octa-core processor and 3GB RAM as well as various data capture options : Barcode, OCR, MSR, Contact & Contactless Smartcard and Fingerprint . The durability of the RP1600 ensures the performance is maintained all day, even in tough weather environment. Work more effectively to serve your customer or citizen in various application field by using RP1600. Work-ready and pocket-sized, RP1600 will bring ultimate mobility with true functionality. This feature-rich RP1600 runs in Android 6.0 Marshmallow. 4.3inch display with compact, pocketable design enables users to carry it conveniently anywhere. The RP1600 is valuable tool for field service operation, utility meter reading, law enforcement, sale force automation, postal service, retail shop operation, and healthcare.



Parking enforcement

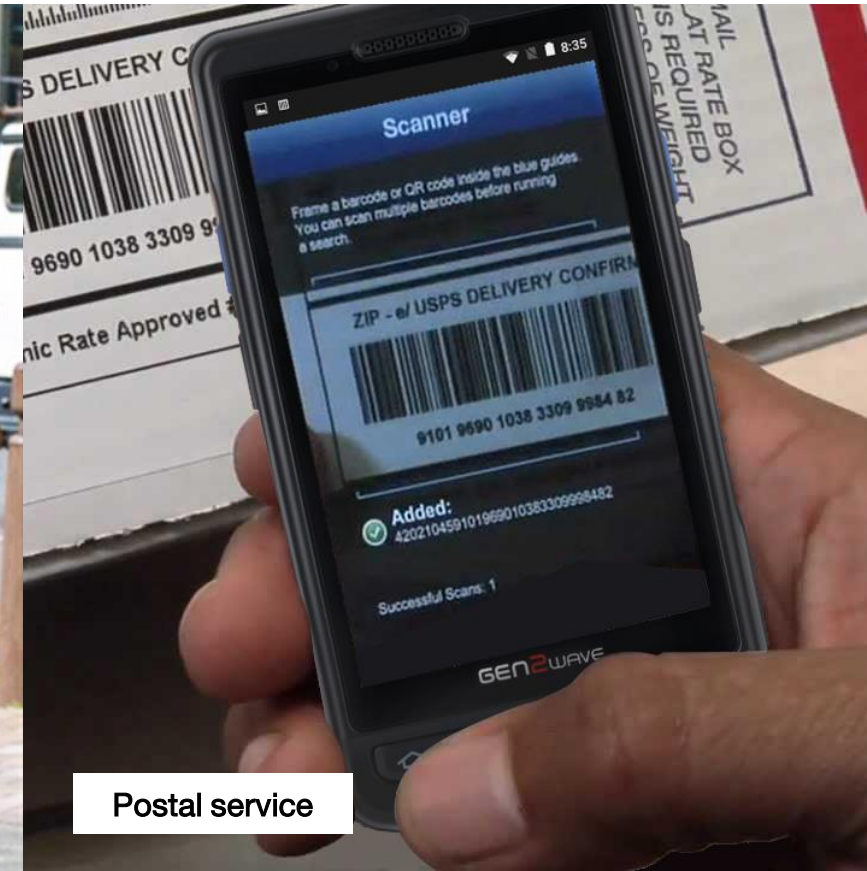

Postal service

Octa-Core Platform Performance

Latest Android platform with

- 1.8GHZ 8-core Processor 1.8GHz (SAMSUNG Exynos)
- Android 6.0 Marshmallow
- 3GB RAM, 16GB ROM

which enables stable and speedy processing



GEN2WAVE RP1600
Samsung Exynos 5430
Octa(8)core 1.8GHz
Samsung Exynos PROCESSOR

Honeywell Dolphin 75e
Snapdragon 801
Quad(4)core 2.26GHz

Honeywell Dolphin CT50
Snapdragon 801
Quad(4)core 2.26GHz

Zebra TC55 Dual(2)core 1.5GHz
Zebra TC75 Dual(2)core 1.7GHz
Pidion BM180 Dual(2)core 1.5GHz

Comparison of Memory Size

Model	Gen2Wave	Honeywell	Honeywell	Zebra	Zebra	Pidion
	RP1600	CT50	Dolphin 75e	TC75	TC55	BM180
						
RAM	3GB	2GB	2GB	1GB	1GB	1GB
ROM	16GB	16GB	16GB	8GB	8GB	8GB

Antutu Benchmarking Result



RP1600
Gen2Wave

TC55
Zebra

BM180 / BP30
Pidion

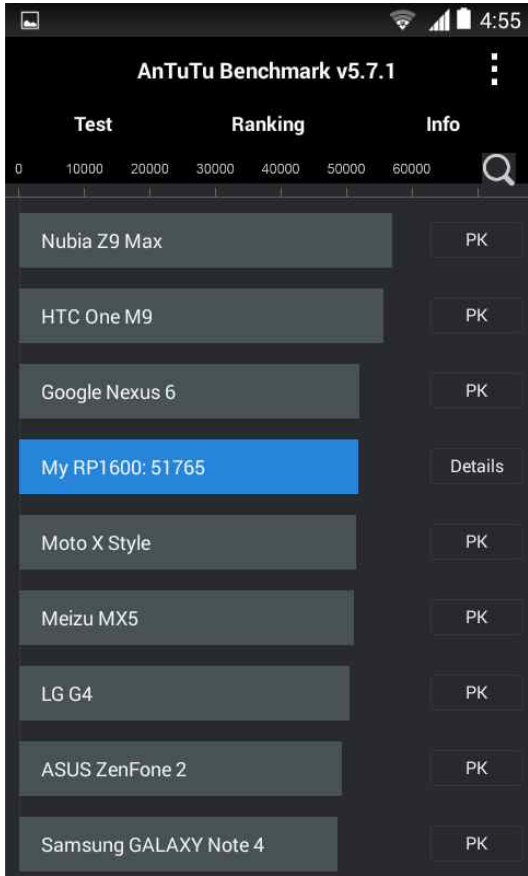
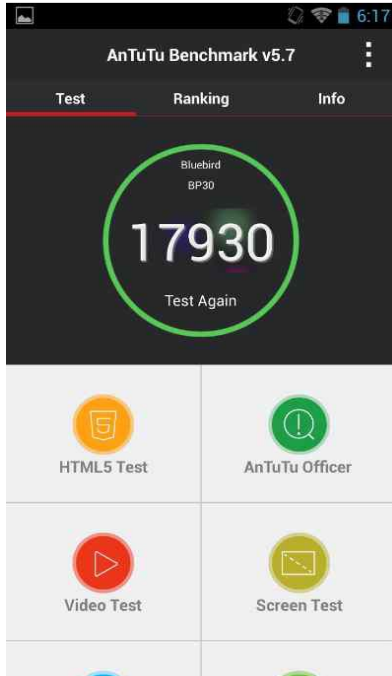
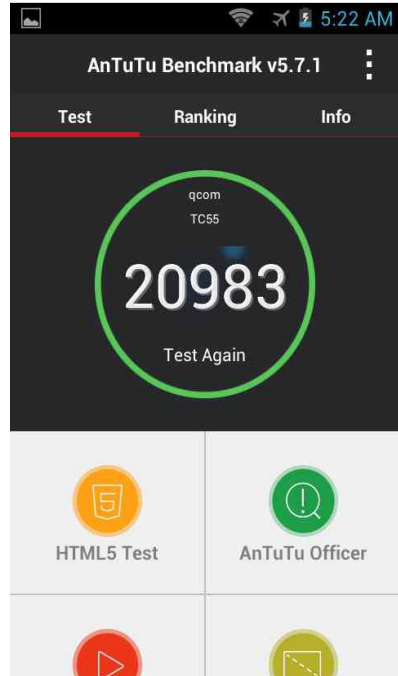
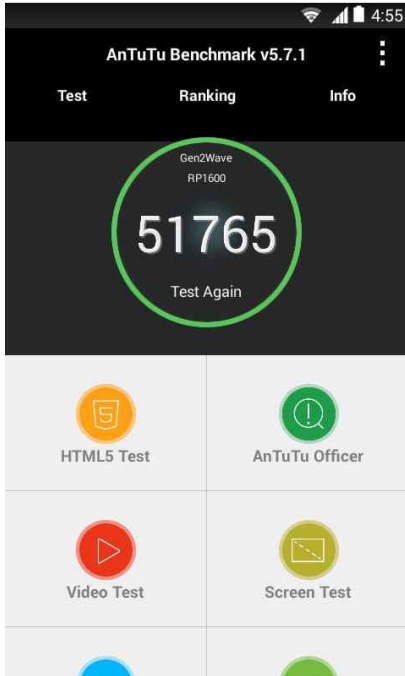

13.0 Mega Pixel High Resolution Camera



Accurate and Reliable Automatic Data Capture



Accurate & Reliable Barcode Scanning

Lightening-fast, most advanced scan engine with longer range data capture capability.

Remarkable working range and wide field of view for distinguishing scanning flexibility.

1D Laser: Zebra SE965

2D Imager: Zebra SE4750



Scanner Performance

	1D Scanner			2D Imager		
Model	Zebra SE965			Zebra SE4750(SR Focus)		
Decoding	Hardware decoder			Software decoder		
Interface	Uart / Lager			MIPI / Image Resolution (1280 horizontal x 960 vertical pixels)		
Typical Performance Narrow Width (1D Barcode)	Symbology	Near Distance	Far Distance	Symbology	Near Distance	Far Distance
	5 mil (Code 128)	3.05 cm (1.2 in)	19.56 cm (7.7 in)	3 mil (Code 39)	7.1 cm (2.8 in)	15.8 cm (6.2 in)
	10 mil (Code 128)	3.05 cm (1.2 in)	48.26 cm (19 in)	5mil (Code 128)	5.8 cm (2.3 in)	22.1 cm (8.7 in)
	100 mil (Code 39)	60.96cm (2 ft)	518.16 cm (17 ft)	20 mil (Code 39)	4.1 cm (1.6 in)	92/2 cm (36.3 in)
Typical Performance Narrow Width (2D Barcode)				5 mil (PDF 417)	7.6 cm (3.0 in)	20.6 cm (8.1 in)
				6.67 mil (PDF 417)	5.6 cm (2.2 in)	26.9 cm (10.6 in)
				10 mil (DataMatix)	6.1 cm (2.4 in)	26.0 cm (10.6 in)

Pocketable and Rugged, IP 64 Waterproof, 1.5M Drop

Dust, spilled coffee or raindrops are no match for RP1600. Born with toughness against dust and water, RP1600 is certified with IP64 sealing, 1.5 meter multitude drop resistant, and operating temperature of -20°C to 60°C.

Both capacitive and resistive touch is available. The RP1600 is adequate to use in any challenging environments.



IP64 sealing



Anti Shock Resistant
By 1.5m drop on Concrete



Gorilla Glass 3 and Capacitive Touch Screen

The touch screen of RP1600 is equipped with 3rd generation Gorilla Glass which provides utmost resistance against shock and scratch. With high sensitivity of the capacitive touch screen, RP1600 allows to be operated with gloved hand, Stylus and bare hands.



Reliable High Speed and Multimode Connectivity

The RP1600 offers latest and advanced technology of connectivity options :

- 4G LTE** Gemalto PLS8-E : LTE , HSPA+, EDGE, GPRS
LTE : 800, 900, 1800, 2600Mhz
HSPA+ : 900, 1800, 2100Mhz
GSM/GPRS/EDGE : 900, 1800Mhz
- WLAN** IEEE 802.11 a/b/g/n/ac
- Bluetooth** V4.2 BLE + HS (BT Headset support)
- AGPS** A-GPS (Ublox-7 Series)



Technical Specification

Performance Characteristics	
CPU	1.8 GHz Octa-core processor (SAMSUNG Exynos)
OS	Android 6.0 Marshmallow
Memory	RAM 3GB, ROM 16GB
Physical Characteristics	
Dimensions	147mm(H) X 78mm(W) X 21mm(D)
Weight	420 gram with standard battery 470 gram with extended battery (4000mAH)
Display	4.3 inch WVGA (Sunlight readable)/480 X800 (Capacitive touch, Resistive touch optional)
Input	5 Front Key / 5 Side key
Battery	Standard battery 2860mAh Li-ion Contact Smart Card Reader (optional)
	Extended battery 4000mAh Li-ion
	Built-in Backup Battery 200mAh Li-Polymer Hot-Swap available
Communication Interface	Host : USB2.0 High Speed Client : USB 2.0 High Speed External Serial RS232C RJ45 Port (1Slot/4Slot Ethernet Cradle) * Only USB Client operates when installing EID 10 PLUS
Notification	Vibration and Charging LED, noise when certain icon is tapped on screen
Audio	Speaker / Receiver / MIC
Expansion Slot	Micro SD card(up to 32GB)

User Environment	
Operation Temp.	-20 °C ~ +60 °C (-4°F~140°F)
Storage Temp.	-30 °C ~ +70 °C (-22°F ~158° F)
Humidity	Non-condensing, 93%
Sealing	IP64
Drop Spec.	1.5M drop to concrete
Wireless Communication	
Wireless(WWAN)	Gemalto PLS8-E : LTE, HSPA+, EDGE, GPRS LTE : 800, 900, 1800, 2600Mhz HSPA+ : 900, 1800, 2100Mhz GSM/GPRS/EDGE : 900, 1800Mhz
	Wireless LAN IEEE 802.11 a/b/g/n/ac
	Bluetooth Bluetooth V4.2 BLE + HS (BT Headset support)
GPS	A-GPS (Ublox-7 Series)
Data Capture	
Barcode Scanner	1D Laser Zebra SE965
	2D Imager Zebra SE4750
Camera	13.0MP Auto Focus, Flash
Accessory	
Standard Accessories	All in the Giftbox (Desktop Cradle, PSU, USB Cable, Stylus, Screen Protector)

Accessories

Desktop cradle with
USB Type A and B
(Single Slot Cradle)
SDTC-RP1000-UX



Direct auto charger Kit
CLJC-02



Desktop cradle with
USB Type A and B, and Ethernet
(Single Slot Cradle)
SDTC-RP1000-UE



Multi-gender Snap On
for Ethernet (RJ-45),
Auto-charge, Direct
cable charge, USB Client,
Ear-phone connector
MTG-RP1000-UE



Ethernet 4 slot cradle with PSU
(4 slot Cradle)
4DTC-RP1000-UE



Direct Adaptor Cable
For Serial Connection/
USB Host/Headset
CAT-RP1000-CSM



Vehicle Cradle Charging &
RS232 connection with
suction fixation kit
VC-RP1000-CS



Scanning Handle
SH-RP1000



Mobile Biometric & ID reader EID10 Plus

EID10Plus combined with RP1600 enables all kinds of ID verification

: OCR(MRZ), MRS, Fingerprint Reader, Contact-type smartcard, NFC, Barcode Reader.

EID10 Plus will be a great tool for law enforcement, benefit delivery, and any kind of Mobile ID verification .



Key Supporting Tools

1. G2W Auto Setup
2. G2W KIOSK
3. OTA
4. Device Self Test
5. Extended Wifi Setting
6. Barcode Scanner Emulator

1. G2W Auto Setup

Powerful tool to automatically install applications and configure identical settings to multiple devices in an efficient way

Make your device setting with G2W Auto Setup and apply it by easy & convenient way

- PC-based editing program provided
- Simple QR code scanning to install custom device settings
- Customer APPLICATION to multiple devices

- Main functions -

Auto Install(APK file)
Auto File Management(Copy, Move, Delete)

Auto Wireless Setting
(WWAN APN/ Ethernet connection)

Auto Device Setting
(Key Mapping, Time Zone, Language..)

Easy Installation

Barcode Reading
(2D Imager or Camera)

1. G2W Auto Setup PC-based Easy & Convenient Setting Editor

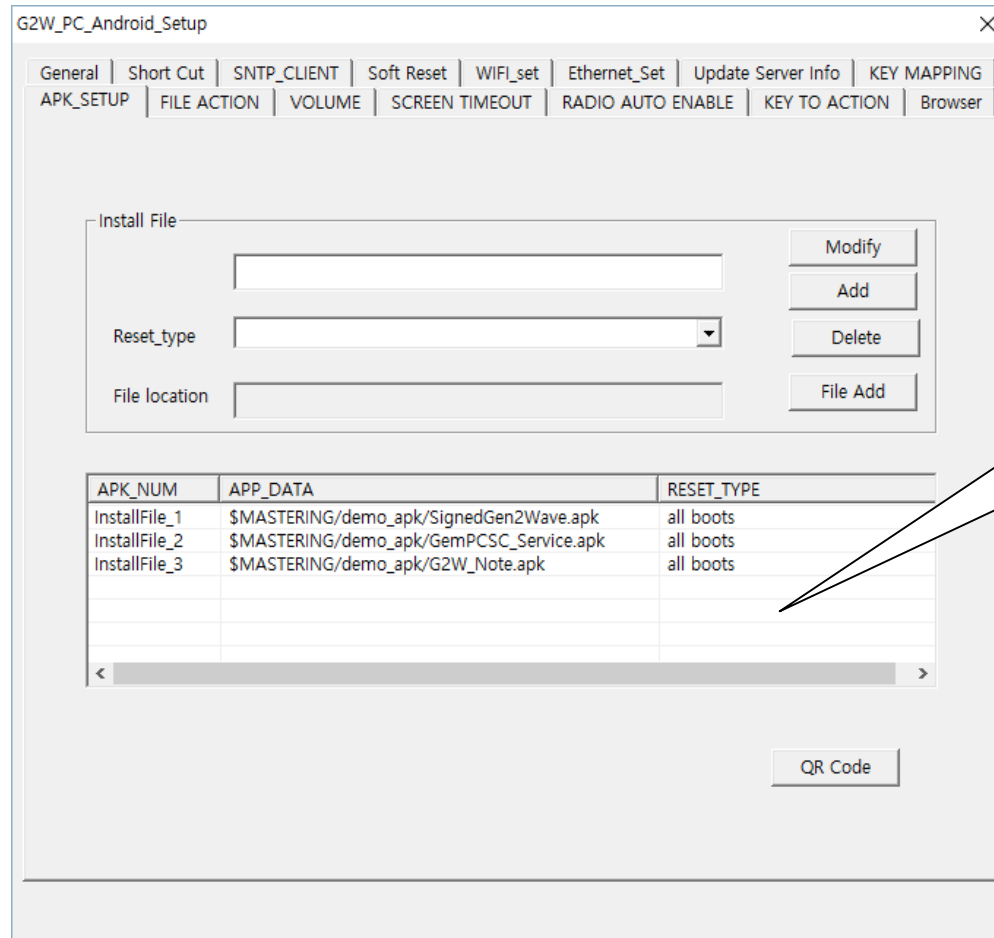

o make your own custom settings
o register all applications and drivers
you need to install

1. G2W Auto Setup

Automatic network establishment & Applying Custom Settings

The screenshot shows a window titled "GEN2WAVE Auto INI Install" with a close button (X) in the top right corner. The window is divided into two main sections: "WIFI Connection" and "FTP Server".

WIFI Connection: A red circle with the number "1" is positioned above the SSID field. The SSID field contains "testAP" and the PASSWORD field contains "1234567890". Below these fields is a "QR code" button.

FTP Server: The IP ADDRESS field contains "192.168.0.10", the ID field contains "gen2wave", the PASSWORD field contains "gen2wave", and the PATH field contains "autoinstall". There is a checked checkbox for "Install Now". Below the fields are two buttons: "Upload INI" (with a red circle and number "2" above it) and "QR code" (with a red circle and number "3" above it).

At the bottom left of the window is an "INI Setting" button.

- I. Set network connection info for devices
- II. Upload Auto Setup/Customer APK
- FTP Server
- III. Create QR code

1. G2W Auto Setup



2D Imager or
Camera

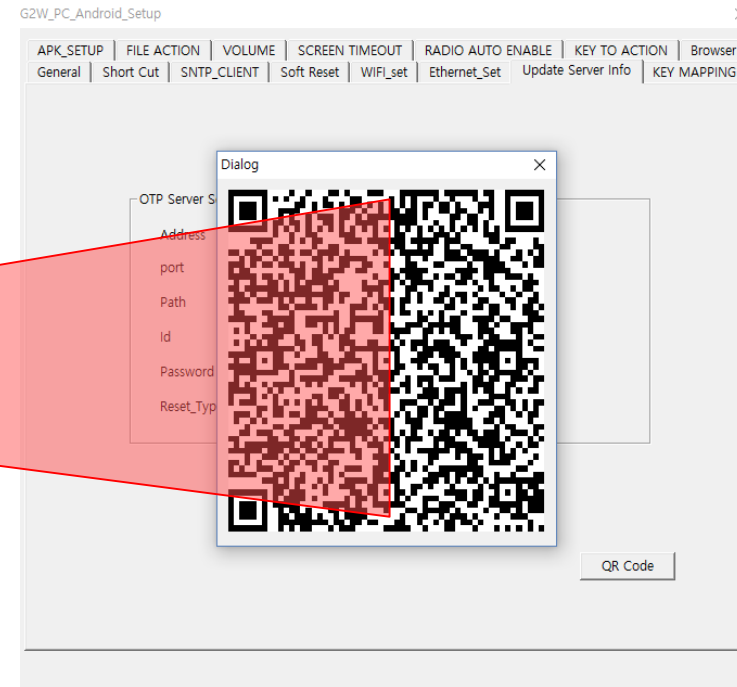

- I. Scan QR code
- II. Automatic connection to FTP server
- III. Automatic download for Auto Setup & APK
- IV. Automatic installation

2. G2W Kiosk

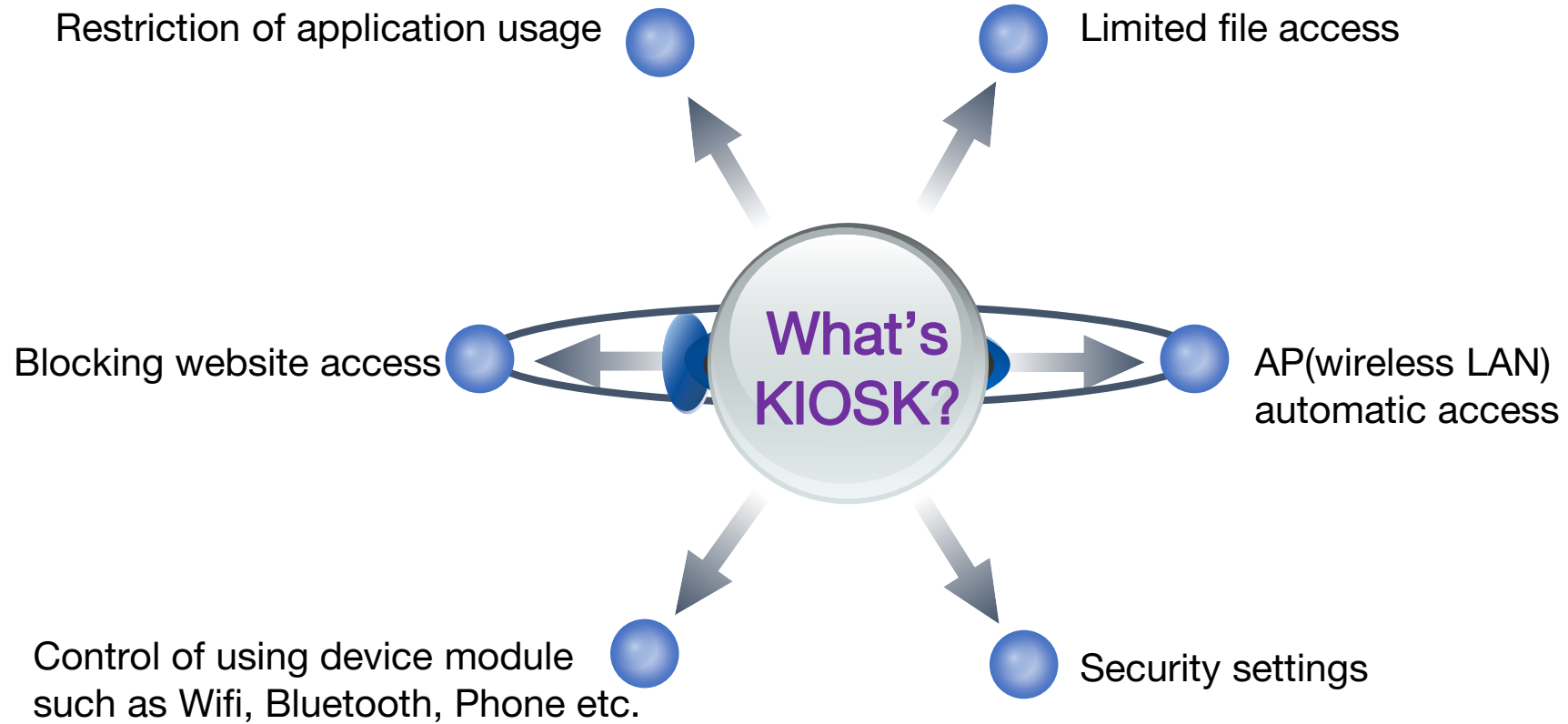

2. G2W Kiosk

User can access designated applications only



2. G2W Kiosk

Only Registered Website accessible

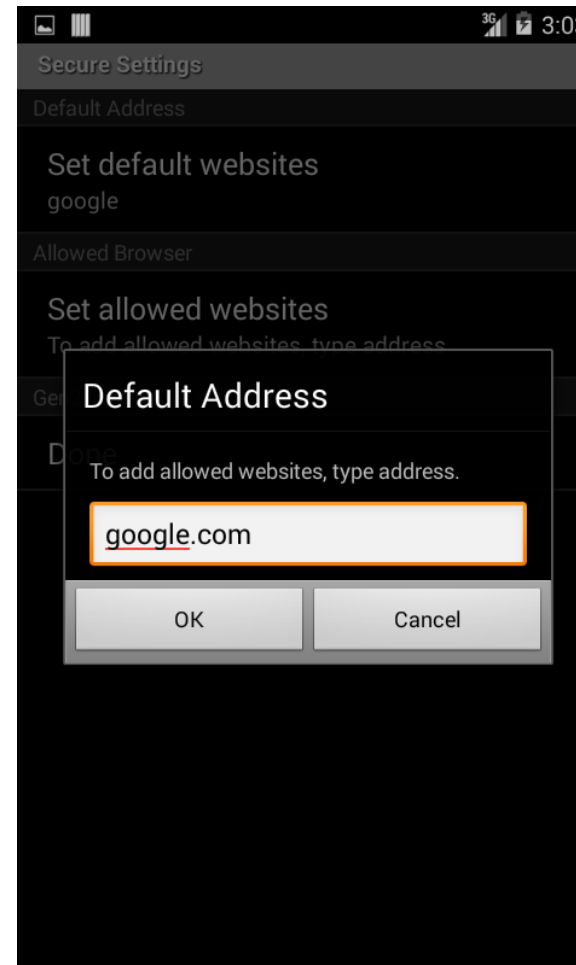
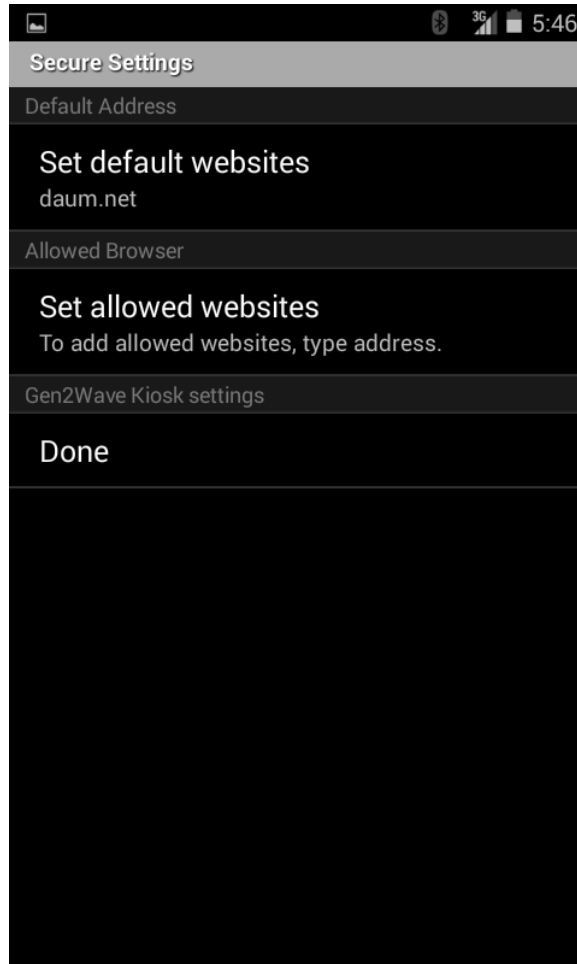

2. G2W Kiosk Easy Apply

- I. Make your own Kiosk setting in your device
- II. Export the setting file to PC
Upload it to FTP server
- III. QR code scanning in “G2W Auto Setup”
- IV. Setting applied automatically.

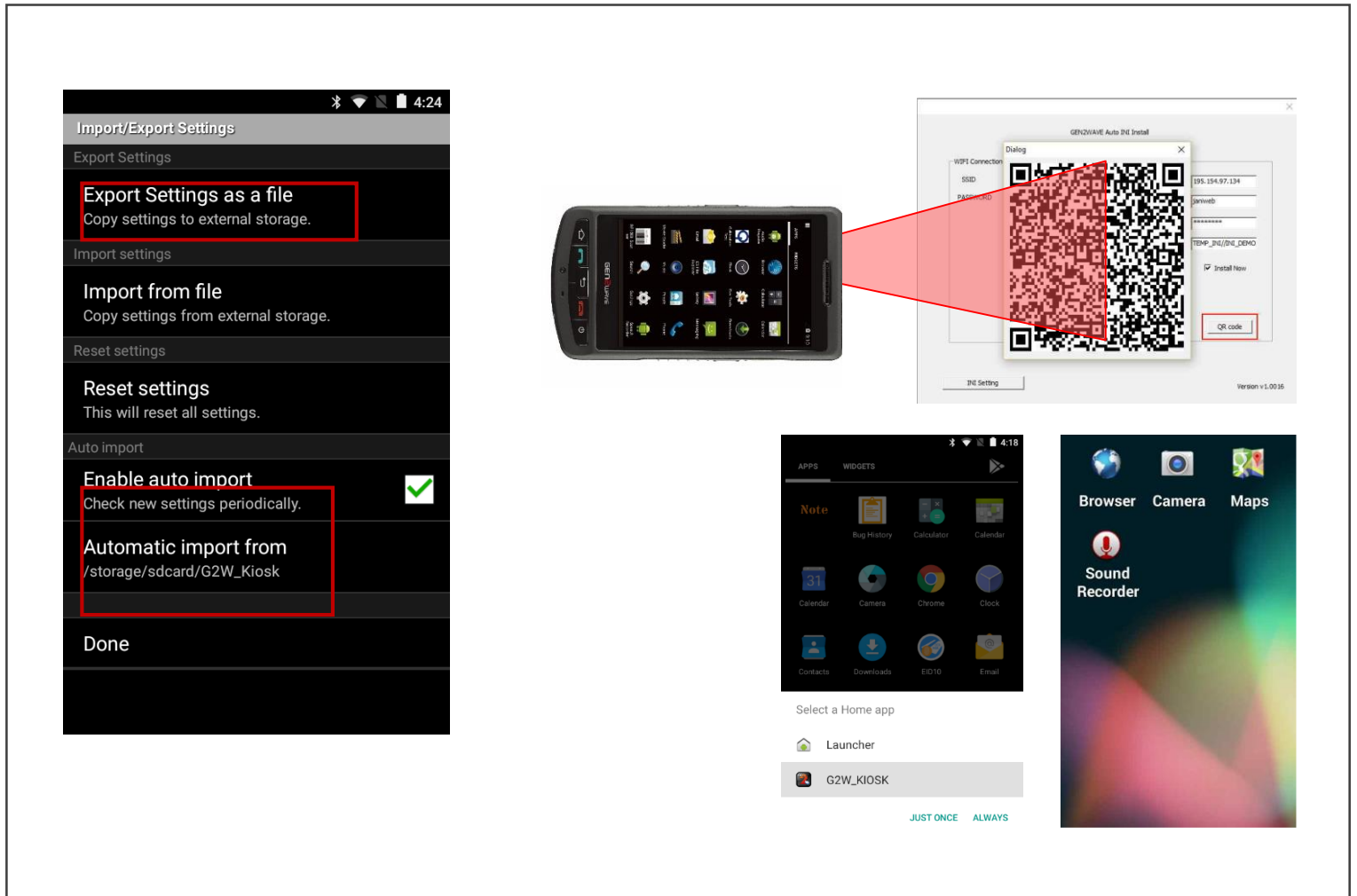

3. OTA

OTA Upgrade

Stable & Secure Server system

supported by “Microsoft Azure Cloud” enabling mass update simultaneously
speedy download using the server located in Europe

Operation of customer’s own FTP server system supported

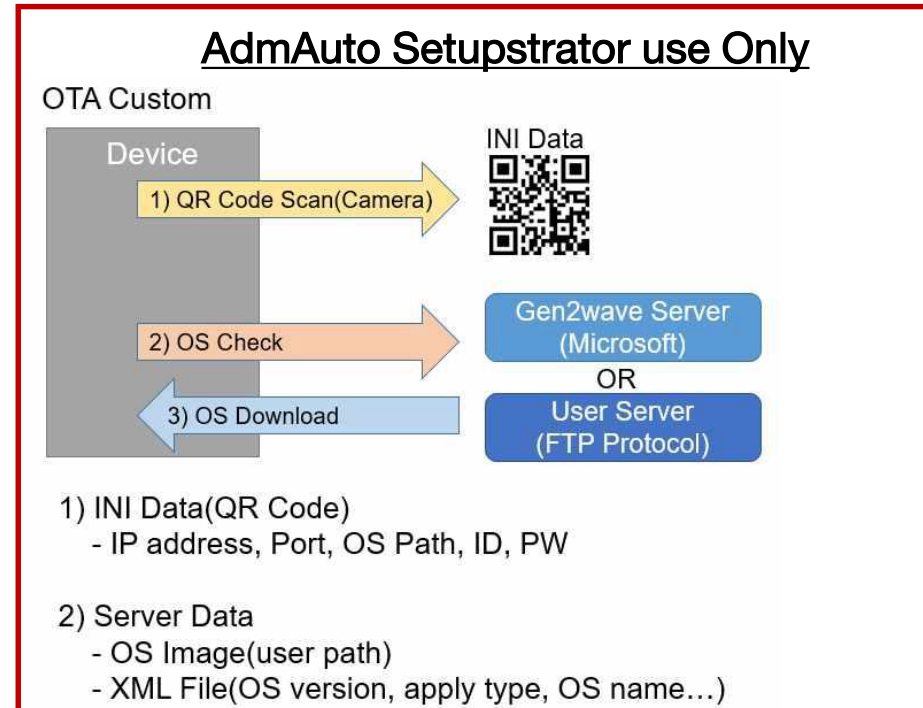
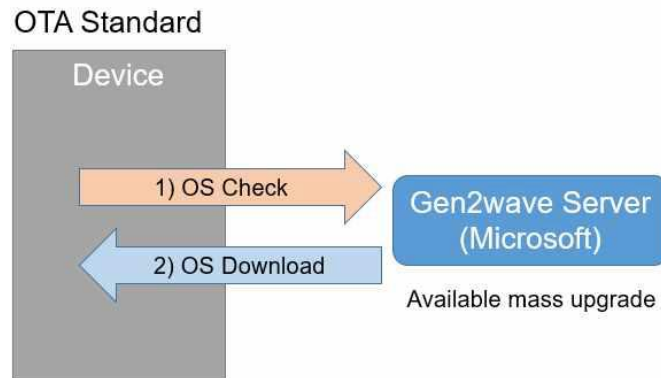

[Remark]

No need to scan QR code in case that OTA network setting is made in Auto Setup.

3. OTA

OTA Windows for Individual Users

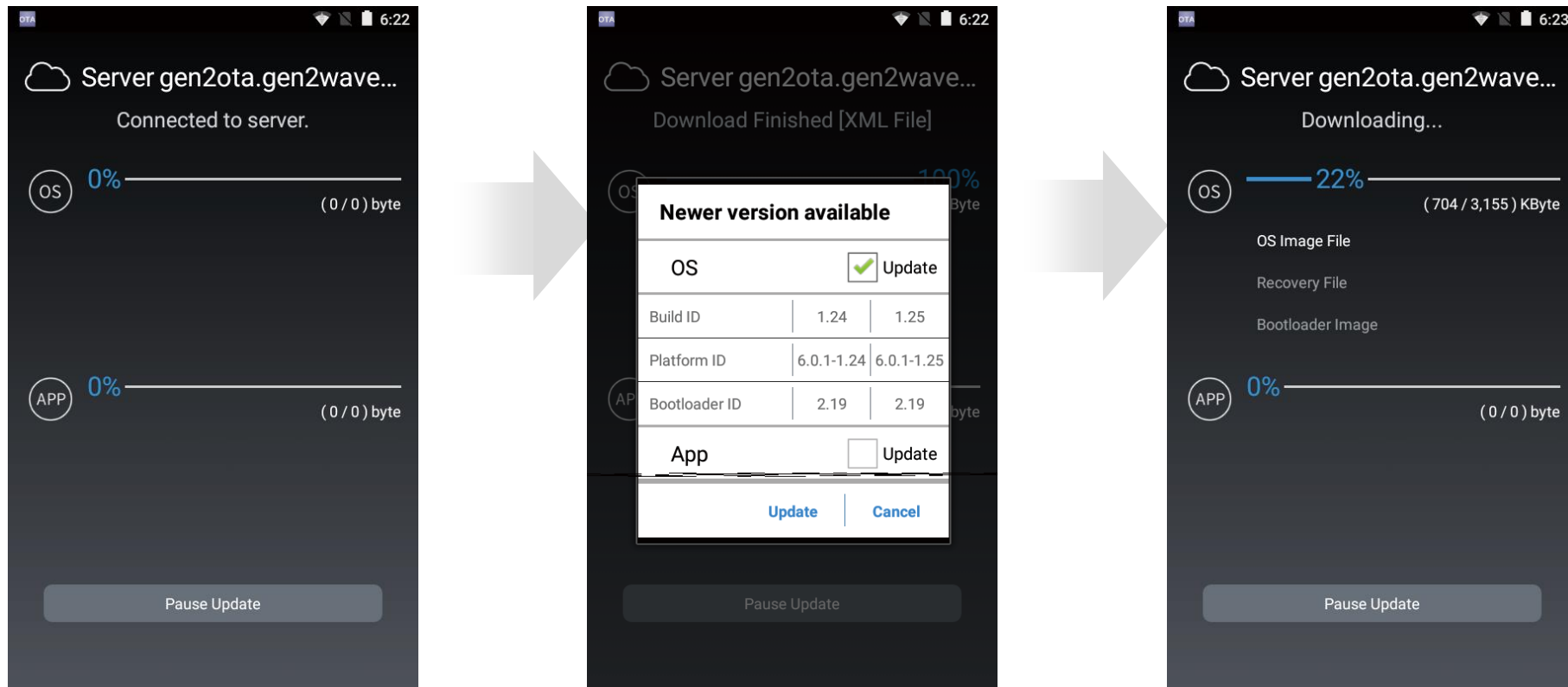

4. Device Self Test

When devices are malfunctioning, users can easily diagnose their devices by themselves using the self-test program



5. Extended WI-FI Settings

- Main functions -

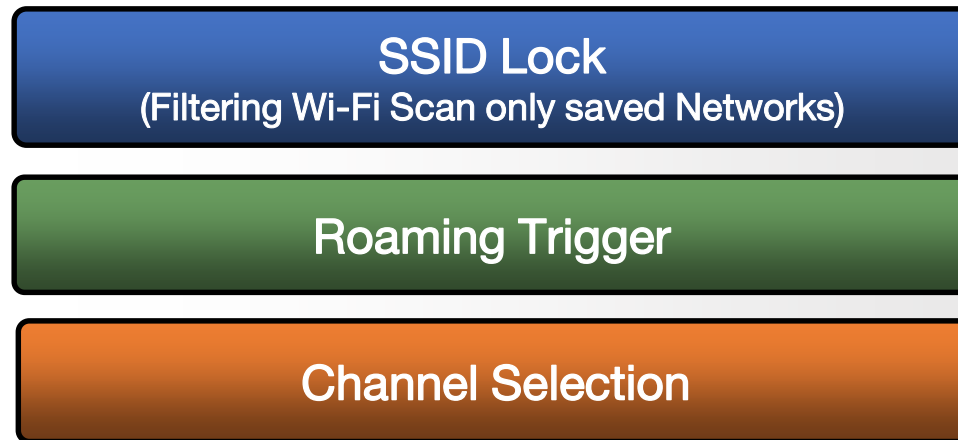

**Stable & Secure
Connection**

5. Extended WI-FI Settings

SSID Lock

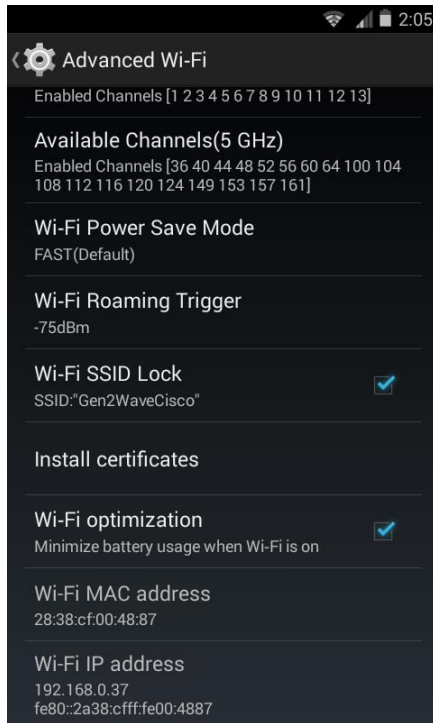

Roaming Trigger

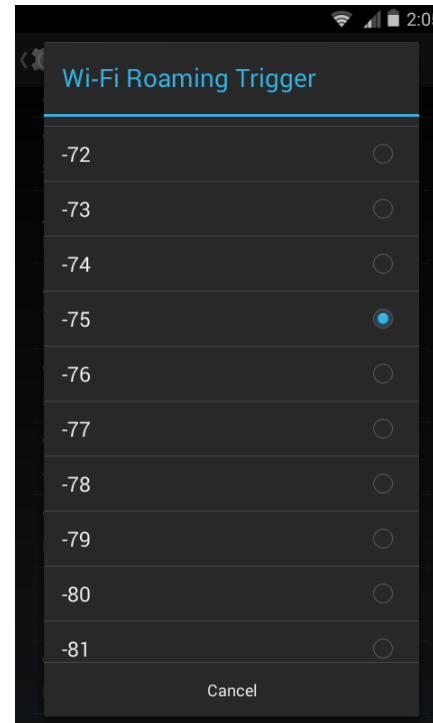

Channel Select

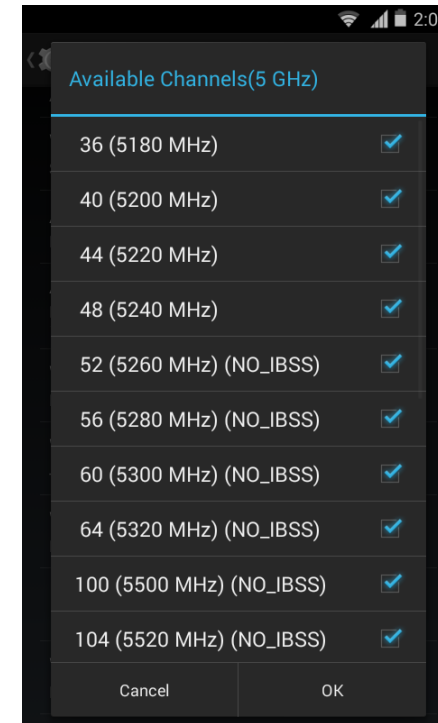

6. Barcode Scanner Emulator

Extended Functions for easy & efficient scanner use

- Main functions -

Various Functions
(Clipboard/Direct, Prefix/Suffix,
Vibration, Multi Reading, Easy Symbology Setting)

Easy / Convenient

6. Barcode Scanner Emulator

Convenient Functions

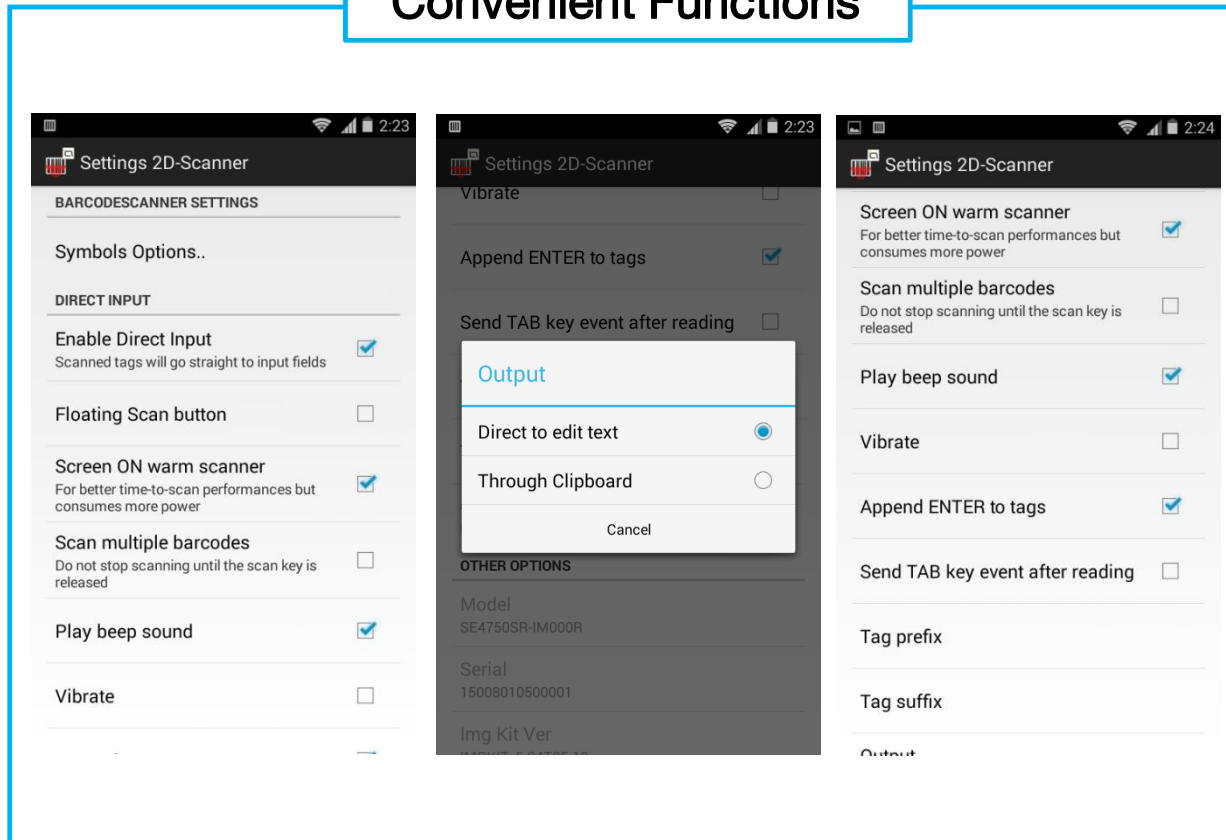

Key Differentiator of RP1600

Key Differentiator of RP1600

- **Powerful Processor & Sizable RAM**
- **Professional Supporting Tools**
- **Full-range of Accessories**

Application



Law Enforcement



Logistics



Transportation





